

NOTE:
FOR ACCURATE RIGHT OF WAY DATA, CONTACT
RIGHT OF WAY ENGINEERING AT THE DISTRICT OFFICE.

Dist:	COUNTY:	ROUTE:	POST MILE:	SHEET:	TOTAL:
03	ED, PIG	89	21.27214	15	15
			TOTAL PROJECT:		
			0.0/18.5		

Manny H. Bruton
 REGISTERED CIVIL ENGINEER DATE: 2-28-11

PLANS APPROVAL DATE: 2-28-11
 THE STATE OF CALIFORNIA OR ITS OFFICERS OR AGENTS SHALL NOT BE RESPONSIBLE FOR THE ACCURACY OR COMPLETENESS OF SCANNED COPIES OF THIS PLAN SHEET.

REGISTERED PROFESSIONAL SEAL
 M. H. BRUTON
 No. 52899
 Exp. 12-31-17
 CIVIL
 STATE OF CALIFORNIA

STATE OF CALIFORNIA - DEPARTMENT OF TRANSPORTATION
 NORTH REGION
 DIVISION OF ENGINEERING

FUNCTIONAL SUPERVISOR
 K. KEATON

CALCULATED/DESIGNED BY
 M. BRUTON

CHECKED BY
 F. PLAMAS

REVISIONS
 REVISION NO. DATE REVISION BY

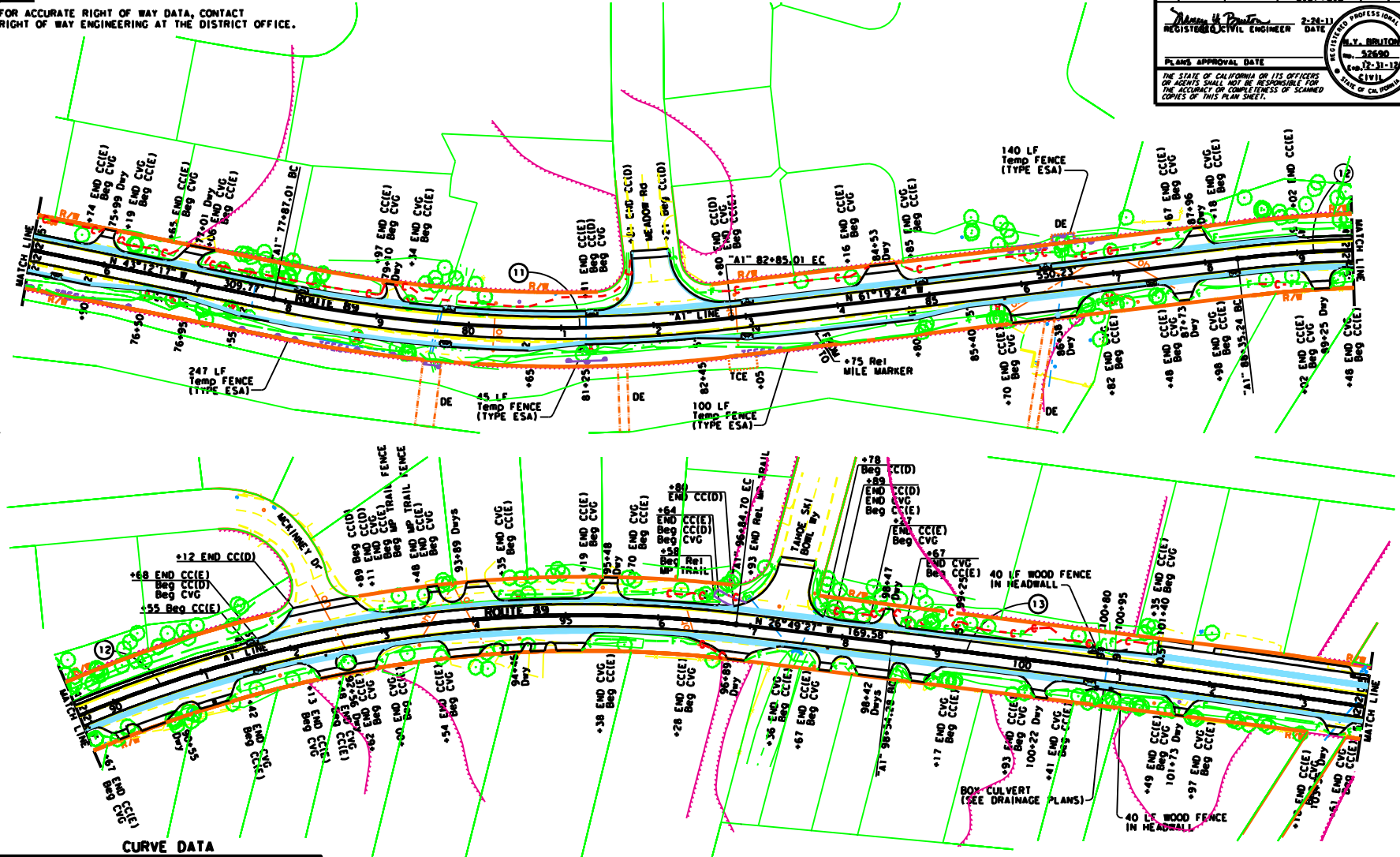

NO.	R	Δ	T	L
(1)	1574.80'	18°07'08"	251.10'	498.00'
(2)	1410.76'	34°29'58"	438.04'	849.46'
(3)	16404.17'	03°30'51"	503.24'	1006.16'

LAYOUT
SCALE: 1" = 50'

L-5

NOTE:
FOR ACCURATE RIGHT OF WAY DATA, CONTACT
RIGHT OF WAY ENGINEERING AT THE DISTRICT OFFICE.

Dist:	COUNTY:	ROUTE:	POST MILES:	SHEET:	TOTAL:
03	ED, PIG	89	21.2721, 4.0, 0.0/18.5	14	115

M. H. DUNN
 REGISTERED CIVIL ENGINEER
 DATE: 2-28-11

PLANS APPROVAL DATE: 2-28-11
 THE STATE OF CALIFORNIA OR ITS OFFICERS OR AGENTS SHALL NOT BE RESPONSIBLE FOR THE ACCURACY OR COMPLETENESS OF SCANNED COPIES OF THIS PLAN SHEET.

M. H. DUNN
 REGISTERED PROFESSIONAL ENGINEER
 No. 52690
 Exp. 12-31-17
 CIVIL
 STATE OF CALIFORNIA

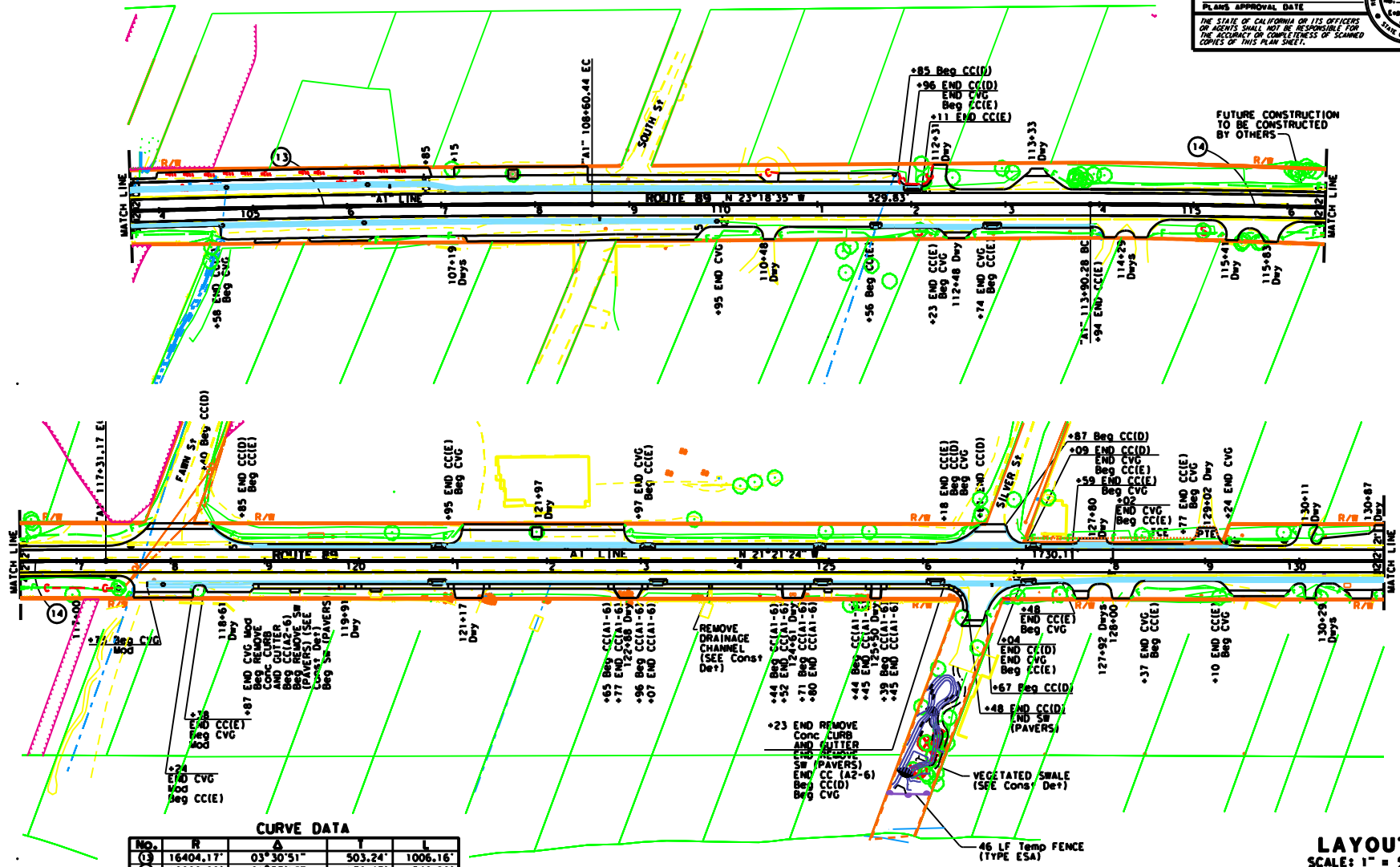

CURVE DATA

No.	R	Δ	T	L
(3)	16404.17'	03°30'51"	503.24'	1006.16'
(4)	10000.00'	01°57'12"	170.47'	340.90'

LAYOUT
SCALE: 1" = 50'
L-6

STATE OF CALIFORNIA - DEPARTMENT OF TRANSPORTATION
 NORTH REGION
 DIVISION OF ENGINEERING
 FUNCTIONAL SUPERVISOR: K. KEATON
 CALCULATED/DESIGNED BY: N. DRUTON
 CHECKED BY: F. PLANAS
 REVISIONS: DATE PLOTTED: 11/20/10
 00-00-00 THE PLOTTED IS AT THE