

STATE OF CALIFORNIA - DEPARTMENT OF TRANSPORTATION
 NORTH REGION
 DIVISION OF ENGINEERING

FUNCTIONAL SUPERVISOR
 K. KEATON

DESIGNED BY
 N. BRUNTON

CHECKED BY
 F. PLAMAS

NOTE:
 FOR ACCURATE RIGHT OF WAY DATA, CONTACT
 RIGHT OF WAY ENGINEERING AT THE DISTRICT OFFICE.

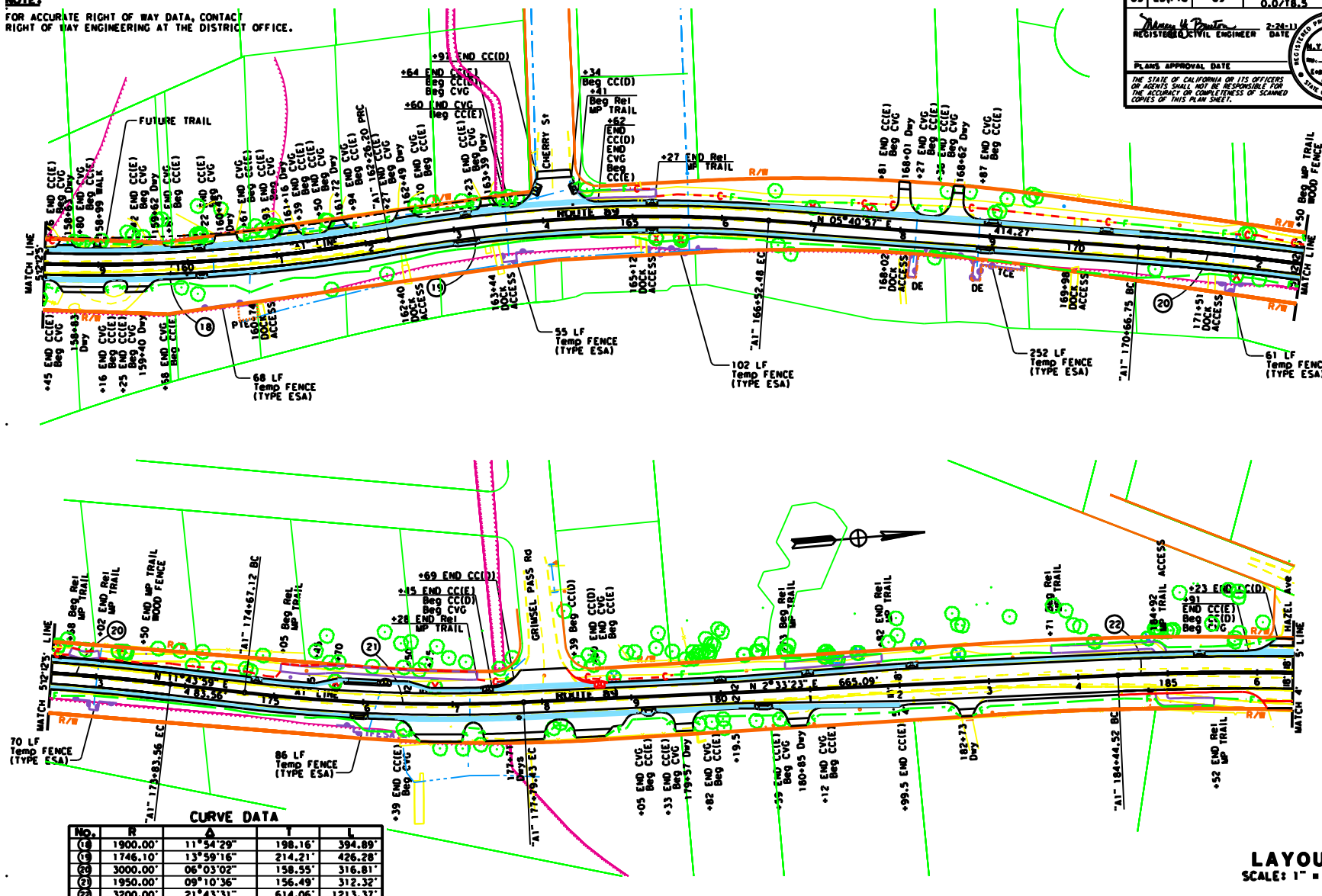

CURVE DATA

NO.	R	Δ	T	L
(1)	1900.00'	11°54'29"	198.16'	394.89'
(2)	1746.10'	13°59'16"	214.21'	426.28'
(3)	3000.00'	06°03'02"	158.55'	316.81'
(4)	1950.00'	09°10'36"	156.49'	312.32'
(5)	3200.00'	21°43'31"	614.06'	1213.37'

Dist:	COUNTY	ROUTE	POST MILES	SHEET NO.	TOTAL SHEETS
03	ED.PIO	89	21.27214	0.0/18.5	

Manuel H. Pantoja
 REGISTERED CIVIL ENGINEER DATE: 2-28-11
 PLANS APPROVAL DATE: 2-28-11
 THE STATE OF CALIFORNIA OR ITS OFFICERS OR AGENTS SHALL NOT BE RESPONSIBLE FOR THE ACCURACY OR COMPLETENESS OF SCANNED COPIES OF THIS PLAN SHEET.

LAYOUT
 SCALE: 1" = 50'
 L-8

NOTE:
FOR ACCURATE RIGHT OF WAY DATA, CONTACT
RIGHT OF WAY ENGINEERING AT THE DISTRICT OFFICE.

Dist:	COUNTY:	ROUTE:	POST MILE:	SHEET NO.:	TOTAL SHEETS:
03	ED, PIG	89	21.2721.4	0.0/18.5	

Manly H. Bruton
 REGISTERED CIVIL ENGINEER DATE: 2-28-11
 THE STATE OF CALIFORNIA OR ITS OFFICERS OR AGENTS SHALL NOT BE RESPONSIBLE FOR THE ACCURACY OR COMPLETENESS OF SCANNED COPIES OF THIS PLAN SHEET.

PLANS APPROVAL DATE: 2-28-11
 REGISTERED PROFESSIONAL SEAL
 M.H. BRUTON
 52890
 00-31-17
 CIVIL
 STATE OF CALIFORNIA

REVISIONS:
 REVISION NO. | DATE | BY | DESCRIPTION
 1 | 11/2/2010 | M. BRUTON | N. BRUTON
 2 | 11/2/2010 | F. PLAMAS | F. PLAMAS
 3 | 11/2/2010 | K. KEATON | K. KEATON

CALCULATED BY: M. BRUTON
 DESIGNED BY: F. PLAMAS
 CHECKED BY: K. KEATON
 FUNCTIONAL SUPERVISOR: K. KEATON
 NORTH REGION DIVISION OF ENGINEERING

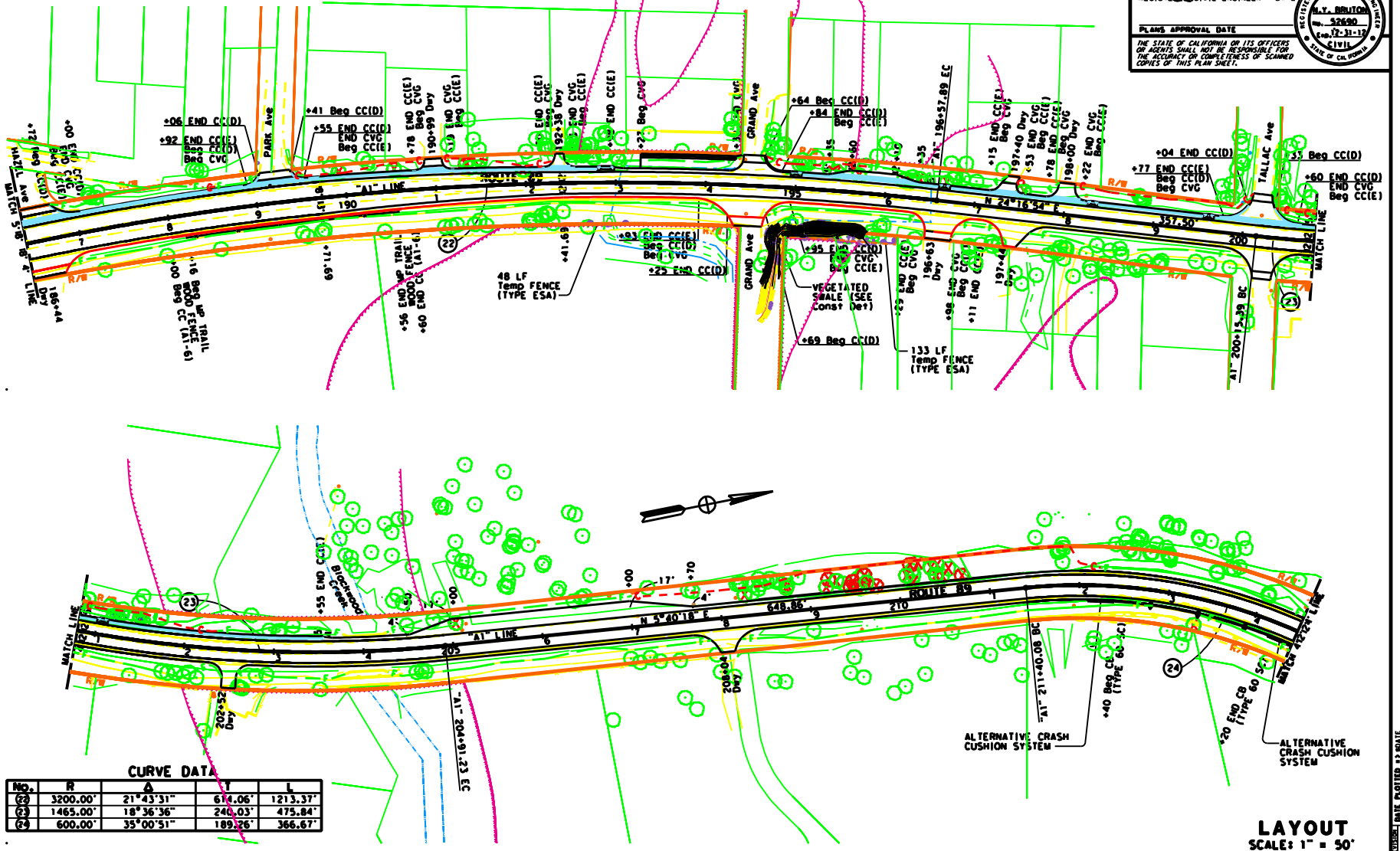

CURVE DATA

NO.	R	Δ	T	L
(2)	3200.00'	21°43'31"	614.06'	1213.37'
(3)	1465.00'	18°36'36"	246.03'	475.84'
(4)	600.00'	35°00'51"	189.26'	366.67'

LAYOUT
SCALE: 1" = 50'
L-9