

NOTES:

1. FOR ACCURATE RIGHT OF WAY DATA, CONTACT RIGHT OF WAY ENGINEERING AT THE DISTRICT OFFICE.
2. ALL UTILITIES SHOW AS IN APPROXIMATE LOCATION. FOR ADDITIONAL UTILITY INFORMATION, SEE UTILITY PLANS.
3. ALL DRAINAGE INLETS AND SAND TRAPS SHALL BE SET TO MATCH GUTTER GRADE.
4. TOP OF GRATE ELEVATIONS SHOWN ARE 0.1" BELOW NORMAL GUTTER FLOW LINE, WHERE APPLICABLE. ALL INLETS WITHIN CONCRETE GUTTERS SHALL INCLUDE A STANDARD GUTTER DEPRESSION EXCEPT TYPE G4 (MOD). PIPE INLET GRATES IN PAVED AREAS SHALL BE RECESSED 1/4" BELOW FINISHED GRADE.
5. CALL OUTS REFERENCE CENTER OF GRATE FOR ROUND GRATES AND CENTER OF GRATE LONGITUDINALLY AT DEPRESSED GRATE FLOWLINE FOR RECTANGULAR GRATES.
6. ALL PORTIONS OF CULVERTS WITH LESS THAN 2'-0" BETWEEN THE TOP OF PIPE AND FINISHED GRADE SHALL HAVE CONCRETE BACKFILL.
7. CONCRETE FLARED END SECTIONS ARE PER STD PLAN D94B EXCEPT THAT "C" DIMENSION WILL BE PAID FOR AS PIPE IT IS CONNECTED TO. CONNECTION SHALL BE WITH "REINFORCED CONCRETE COLLAR." ALTERNATIVE CONNECTIONS ALLOWED WITH APPROVAL OF THE ENGINEER.

ABBREVIATIONS:

- CEP COUNTY ENCROACHMENT PERMIT
 DE DRAINAGE EASEMENT
 TCE TEMPORARY CONSTRUCTION EASEMENT
 CIPP CURED-IN-PLACE PIPE LINER
 CFES CONCRETE FLARED END SECTION
 RED ROCK ENERGY DISSIPATOR
 ST SAND TRAP
 SV SAND VAULT
 W/ WITH

LEGEND:

- ENVIRONMENTALLY SENSITIVE AREAS
 DRAINAGE SYSTEM
 DRAINAGE UNIT

| | | | | | |
|-------|---------|--------|----------------|---------|--------|
| Dist: | COUNTY: | ROUTE: | POST MILE: | SHEET: | TOTAL: |
| 03 | ED, P10 | 89 | 21.27214 | 24 | 115 |
| | | | TOTAL PROJECT: | 0.07183 | |

Thomas R. Ruttsch 2-24-11
 REGISTERED CIVIL ENGINEER DATE

PLANS APPROVAL DATE

THE STATE OF CALIFORNIA ON ITS OFFICERS OR AGENTS SHALL NOT BE RESPONSIBLE FOR THE ACCURACY OR COMPLETENESS OF SCANNED COPIES OF THIS PLAN SHEET.

THOMAS R. RUTTSCH
 No. 47797
 CIVIL
 12-31-11
 STATE OF CALIFORNIA

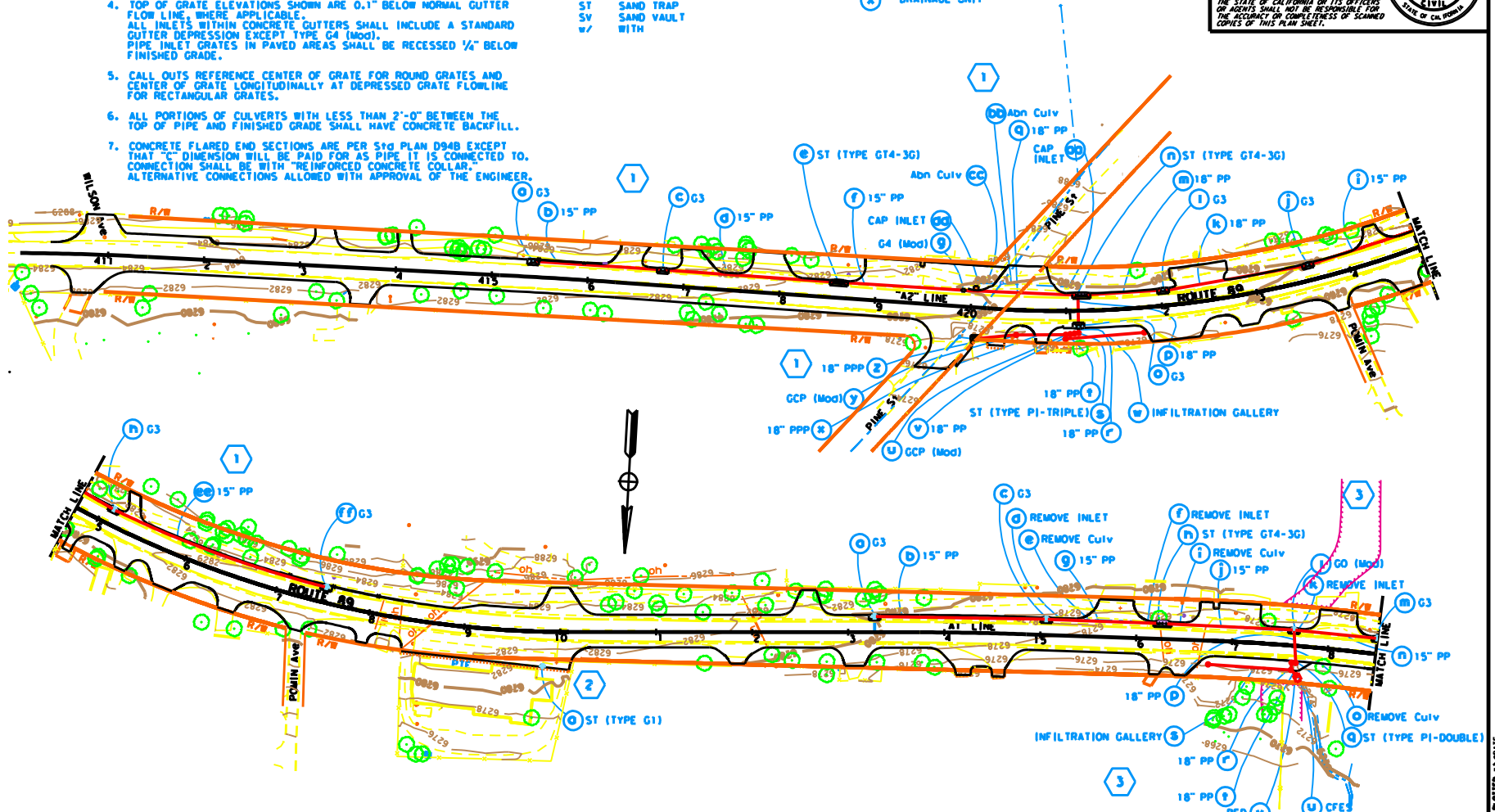

DRAINAGE PLAN
 SCALE: 1" = 50'

D-1

THIS PLAN ACCURATE FOR DRAINAGE WORK ONLY

BORDER LAST REVISED 7/2/2010

USERNAME ==> BUSER
 DGN FILE ==> BREQ0521

RELATIVE BORDER SCALE
 15 IN INCHES



UNIT 0323

PROJECT NUMBER & PHASE

0300002971

REVISOR: V. LAO
 DATE: T. RUTSCH

FUNCTIONAL SUPERVISOR
 K. KEATON

STATE OF CALIFORNIA - DEPARTMENT OF TRANSPORTATION
 NORTH REGION
 DIVISION OF ENGINEERING

PLOT NUMBER: 03-00-00 DATE PLOTTED: 03/01/11

NOTE:
FOR ACCURATE RIGHT OF WAY DATA, CONTACT
RIGHT OF WAY ENGINEERING AT THE DISTRICT OFFICE.

| DIST | COUNTY | ROUTE | POST MILE TOTAL PROJECT | SHEET NO. | TOTAL SHEETS |
|------|---------|-------|-------------------------|-----------|--------------|
| 03 | ED, P10 | 89 | 21.27214 0.0/18.5 | | 15 |

Thomas R. Ruttsch
 REGISTERED CIVIL ENGINEER DATE 3-24-11

PLANS APPROVAL DATE 3-24-11
 THE STATE OF CALIFORNIA OR ITS OFFICERS OR AGENTS SHALL NOT BE RESPONSIBLE FOR THE ACCURACY OR COMPLETENESS OF SCANNED COPIES OF THIS PLAN SHEET.

L.A.S. RUTTSCH
 No. 47397
 Exp. 12-31-11
 CIVIL
 STATE OF CALIFORNIA

STATE OF CALIFORNIA - DEPARTMENT OF TRANSPORTATION
 NORTH REGION
 DIVISION OF ENGINEERING

FUNCTIONAL SUPERVISOR
 K. KEATON

CALCULATED/DESIGNED BY
 V. LAO

CHECKED BY
 T. RUTTSCH

REVISED BY
 DATE REVISED

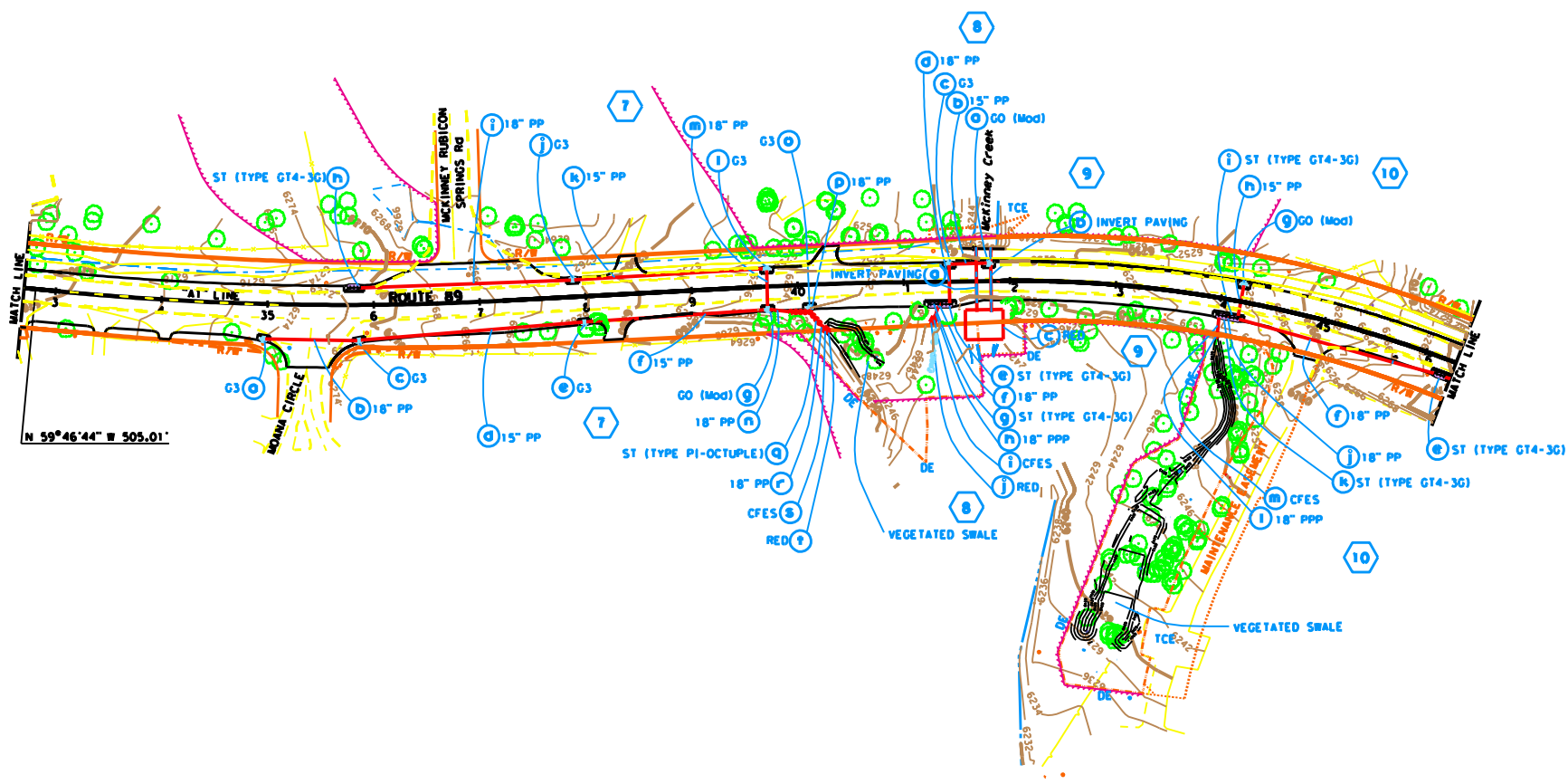

DRAINAGE PLAN
SCALE: 1" = 50'

D-3

THIS PLAN ACCURATE FOR DRAINAGE WORK ONLY

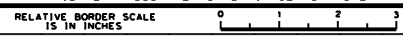

UNIT 0323 PROJECT NUMBER & PHASE 0300002971

DATE PLOTTED: 03/24/11 11:52:40 AM
 DATE PLOTTED: 03/24/11 11:52:40 AM